



MAKE EVERYTHING EASIER



Equipment Rayong Co.,Ltd



@iseerayongservice







ELECTRIC PALLET TRUCK



Li-ion Powered Pallet Truck

CBDS15E

POWERFUL WITH HIGH GRADEABILITY

Traveling speed:unladen:4.5km/h;laden:4km/h
Gradeability:Unladen:20%;800kg:10%;1.5T/2.0T:6%

UNIQUE BRUSHLESS TECHNOLOGY

Brushless motor, powerful and maintenance free.Leading in the industry.

MAINTENANCE FREE

For brushed motor, carbon brush needs to be replaced every 12 or 18 months.
No need to replace carbon brush.

NON-STOP WORKING

6s to replace battery;
Quick charging: 2 hours to fully charge the battery.

COMPACT AND DURABLE

Solid build, no breaking
Most compact unit with same lifting capacity

INTELLIGENT CONTROL

Turtle Speed
Up-Right Drive
Engineering Mode

Model		CBDS15E	CBDS20E
Drive unit		Electrics	Electrics
Operator type		pedestrian	pedestrian
rated capacity	Q (kg)	1500	2000
Load center distance	c (mm)	600	600
Height, fork lowered	h_{13} (mm)	82 ± 2	82 ± 2
Wheelbase	y (mm)	1197/1267	1197/1267
Wheel		PU	PU
Wheel size, front	mm	140*55	140*55
Wheel size, rear	mm	80*93 (Single Wheel)	80*93 (Single Wheel)
	mm	80*70 (Tandem)	80*70 (Tandem)
Wheels, number front/rear (x = drive wheels)		1x+2/4	1x+2/4
Lift	h_3 (mm)	115	115
Height of tiller in drive position, min./max.	h_{14} (mm)	740/1220	740/1220
Overall length	L_1 (mm)	1552/1622	1552/1662
Fork Length	L (mm)	1150/1220	1150/1220
Overall width	B_1 (mm)	550/685	550/685
Fork dimensions	mm	58/160/1150(1220)	58/160/1150(1220)
Distance between fork-arms	B_5 (mm)	550/685	550/685
Ground clearance, centre of wheelbase	mm	22/137(24/139)	22/137(24/139)
Aisle width for pallets 1000x1200 crossways	A_{st} (mm)	2155/2226	2155/2226
Aisle width for pallets 800x1200 lengthways	A_{st} (mm)	2024/2064	2024/2064
Turning radius	W_a (mm)	1353/1426	1353/1426
Travel speed, laden/unladen	Km/h	4.0/4.5	4.0/4.5
Lifting speed, laden/unladen	mm/s	18/23	18/23
Lowering speed, laden/unladen	mm/s	56/46	56/46
Max. gradeability, laden/unladen	%	6/20	6/20
Drive motor	Kw	DC 0.75 Brushless	DC 1.0 Brushless
Lift motor	Kw	DC 0.8	DC 0.8
Battery voltage/nominal capacity	V/Ah	48V/10Ah(48V/15Ah)	48V/10Ah(48V/15Ah)
Traveling brake		Regenerate	Regenerate
Brake		Electromagnetic	Electromagnetic
Sound level at the driver's ear according to EN 12053	A	< 70dB	< 70dB
Service weight including battery	kg	116.5/123	119/125.5

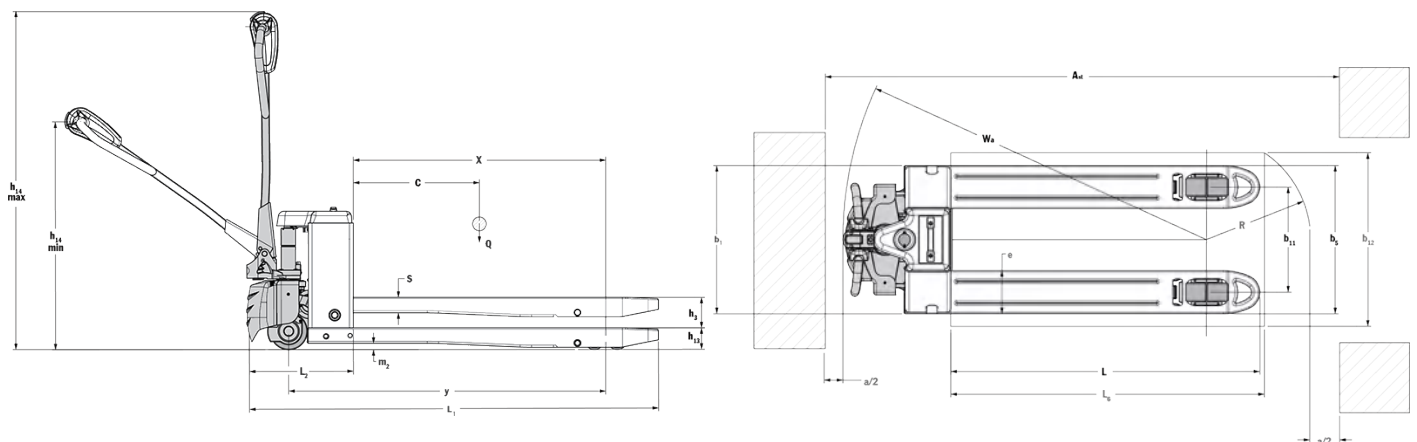



Li-ion Powered Pallet Truck

CBD15W-Lix

MULTI-FUNCTION CONTROL HANDLE

incorporates butterfly-style thumb controls, emergency reverse button, horn button and key switch for ease of use.

ERGONOMIC SPRING-LOADED

steering handle with comfort grip for reduced operator fatigue.

WITH EM BRAKE OFFERS REGENERATIVE BRAKING

PLUG-IN BATTERY DESIGN

makes it easier to remove and change, no need additional tools or devices.

INTEGRATED ROCKER ARM

The rocker arm is casted in single piece, intensifying the strength and structure.

COMPACT VEHICLE DESIGN

Rugged and high-performing yet light weight body provides exceptional maneuverability in tight areas.

LESS WIRING, EASY SERVICE

Mechanical and electronic components are easy to change and service.

BRUSHLESS MOTOR

Equipped with horizontal type brushless driving motor and gear box, offers high drive speed and low torque output, wheel can be independently dismantled.



Conforms to
ISO3691-1 EN1175-1
EN12053 EN12895
EN12100 EN16307-1

Model		CBD15W-Lix
Drive: electric (battery type, mains, ...), diesel, petrol, fuel gas		Electric
Operator type: hand, pedestrian, standing, seated, order-picker		Pedestrian
Rated capacity/rated load	Q (kg)	1500
Load centre distance	c (mm)	600
Load distance, centre of drive axle to fork	x (mm)	951/1021
Wheelbase	y (mm)	1270/1340
Service weight	kg	135
Axle loading, laden front/rear	kg	565/1070
Axle loading, unladen front/rear	kg	105/30
Tyres: solid rubber, superelastic, pneumatic, polyurethane		Polyurethane(PU)
Tyre size, front		Φ210x70
Tyre size, rear		Φ80x93/Φ80x70
Additional wheels (dimensions)		44x17
Wheels, number front/rear (x = driven wheels)		1x-2/2(4)
Tread, front	b ₁₀ (mm)	321
Tread, rear	b ₁₁ (mm)	390/525
Lift	h ₃ (mm)	110
Height drawbar in driving position min./max.	h ₁₄ (mm)	635/1200
Height, lowered	h ₁₃ (mm)	80
Overall length	l ₁ (mm)	1623/1693
Length to face of forks	l ₂ (mm)	473
Overall width	b ₁ /b ₂ (mm)	550/685
Fork dimensions DIN ISO 2331	s/e/l (mm)	45/160/1150(1220)
Fork spread	b ₅ (mm)	550/685
Ground clearance, centre of wheelbase	m ₂ (mm)	35
Aisle width for pallets 1000 × 1200 crossways	Ast (mm)	2226/2294
Aisle width for pallets 800 × 1200 lengthways	Ast (mm)	2095/2132
Turning radius	Wa (mm)	1424/1494
Travel speed, laden/unladen	km/h	4.8/5
Lift speed, laden/unladen	m/s	E
Lowering speed, lade/unladen	m/s	0.03/0.035
Max. gradeability, laden/unladen	%	5/20
Service brake		Electromagnetic
Drive motor rating S2 60 min	kW	0.65
Lift motor rating at S3 15%	kW	0.8
Battery voltage/nominal capacity K5	(V)/(Ah) or kWh	48/20
Battery weight	kg	8.5
Sound pressure level at the driver' s seat	dB (A)	70

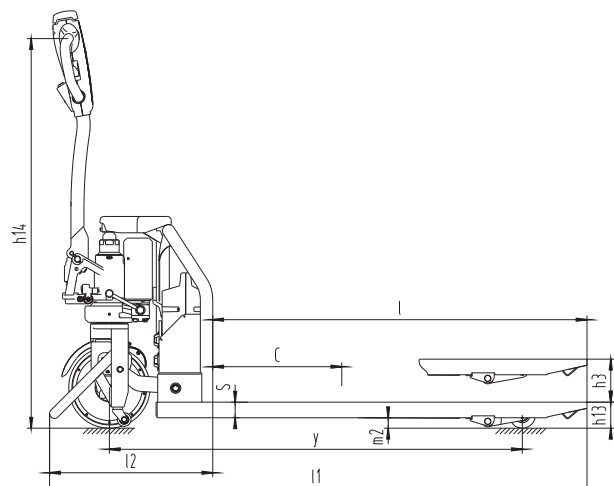

Remarks: CBD15W-UX with horizontal drive motor & EM brake.

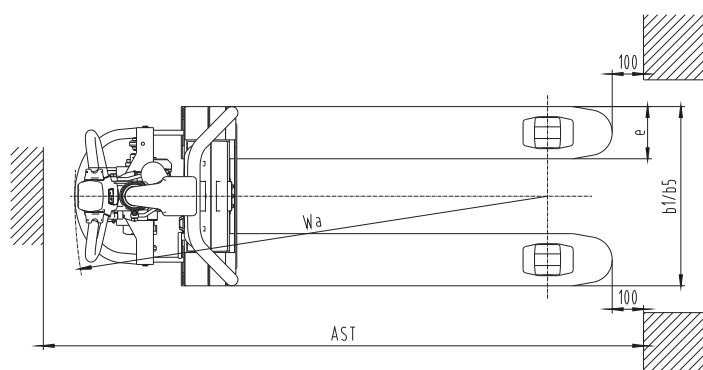



Electric Pallet Truck 1.5T

CBDL15E

- OPTIMIZED STRUCTURE,EASY OPERATION
- NEW DESIGN OF PLUG-IN&OUT BATTERY
- RIGOROUS DESIGN,STABLE OPERATION
- RELIABLE DRIVE SYSTEM

AC

EPS
(Option)



Conforms to EN ISO3691-1
EN1175-1
EN16307-1
Based on Directive 2006/42/EC
Conform to EN Standard 12895
Based on directive: 2014/30/EU (EMC)

Model		CBDL15E
Drive unit		Electrics
Operator type		pedestrian
rated capacity	Q (kg)	1500
Load center distance	c (mm)	600
Load distance	x (mm)	940(875)
Wheelbase	y (mm)	1200(1135)
Service weight (include battery)	kg	160
Axle loading, laden driving side/loading side	kg	555/1105
Axle loading, unladen driving side/loading side	kg	130/30
Tyre type driving wheels/loading wheels		PU/PU
Tyre size, driving wheels (diameter×width)		Φ210x70
Tyre size, loading wheels (diameter×width)		Φ80x60(Φ74x88)
Tyre size, caster wheels (diameter×width)		Φ74x30
Wheels, number driving caster/loading (x=drive wheels)		1x 2/4(1x 2/2)
Track width, front,driving side	b ₁₀ (mm)	450
Track width,rear,loading side	b ₁₁ (mm)	390/(535)
Lift height	h ₃ (mm)	115
Height drawbar in driving position min./max	h ₁₄ (mm)	650/1170
Lowered height	h ₁₃ (mm)	80
Overall length	l ₁ (mm)	1550
Length to face of forks	l ₂ (mm)	400
Overall width	b ₁ /b ₂ (mm)	610(695)
Fork dimensions	s/e/l (mm)	50/150/1150
Outside width of the forks	b ₅ (mm)	540 (685)
Ground clearance, center of wheelbase	m ₂ (mm)	30
Aisle width for pallets 1000 x 1200 crossways	Ast (mm)	2094
Aisle width for pallets 800 x 1200 lengthways	Ast (mm)	2146
Turning radius	Wa (mm)	1330
Travel s peed, laden/ unladen	(km/h)km/h	4.5/5
Lifting speed, laden/ unladen	m/s	0.028/0.031
Lowering speed, laden/ unladen	m/s	0.068/0.043
Max. gradeability , laden/unladen	%	6/16
Serice brake type	tt	Electric
Drive motor rating S2 60 min	kW	0.75
Lift motor rating at S3 15%	kW	0.8
The maximum allowed size battery	mm	270*110*400
Battery voltage/nominal capacity K20	V/Ah	24/30Ah
Battery weight	kg	10
Type of drive control		DC
Steering type		Mechanical
Sound press ure level at the driver's ear	dB (A)	<74

If there are improvements of technical parameters or configurations, no further notice will be given.
The diagram shown may contain non-standard configurations.

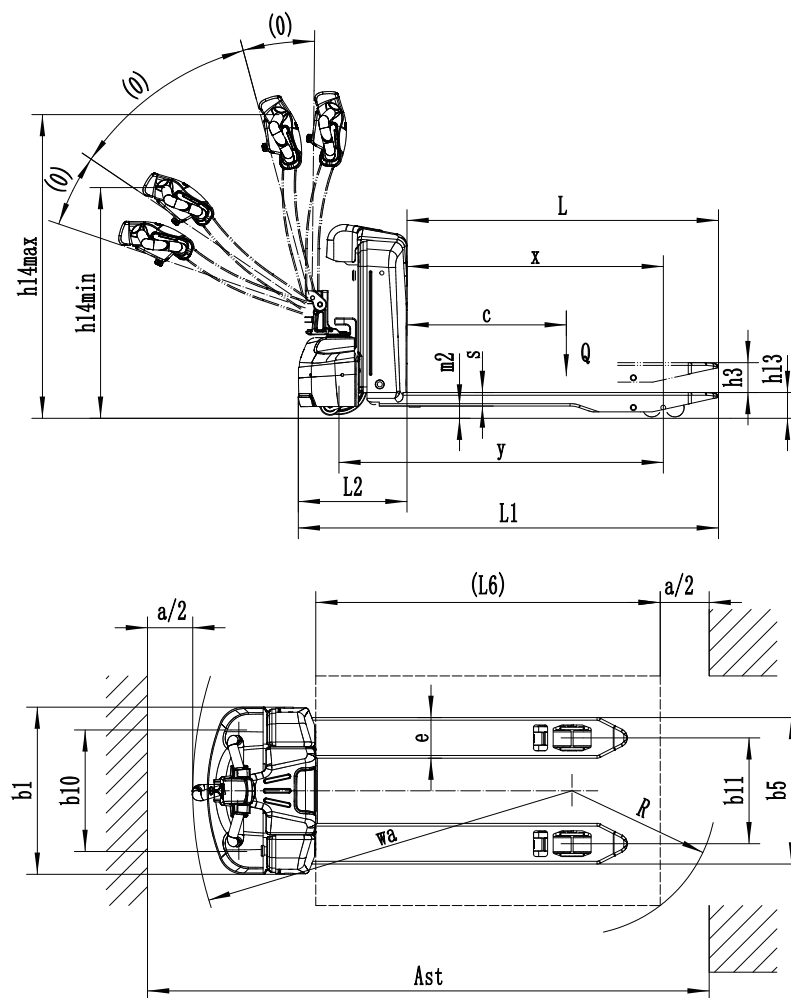

OPTION:

Optional items	CBDL15E
Fork dimension	<ul style="list-style-type: none"> •1150*540◊800*540◊900*540◊950*540◊1000*540◊1070*540◊1220*540◊1300*540◊1400*540 ◊1500*540 ◊800*685◊900*685◊950*685◊1000*685◊1070*685◊1150*685◊1220*685◊1300*685◊1400*685◊1500*685
Fork lowered height	<ul style="list-style-type: none"> •80
Bracket height	<ul style="list-style-type: none"> ◊1220mm (48in) ◊1520mm (60in)
Drive cover off the ground	<ul style="list-style-type: none"> •30mm◊85mm (only for castor wheels option)
Load wheel type	<ul style="list-style-type: none"> •Double◊Single
Load wheel material	<ul style="list-style-type: none"> •PU
Drive wheel material	<ul style="list-style-type: none"> •PU◊Patterned PU
Battery capacity	<ul style="list-style-type: none"> •30Ah
Charger	<ul style="list-style-type: none"> •24V-10A Internal◊24V-10A External◊29.4V/4A External
Battery indicator	<ul style="list-style-type: none"> •With time
Handle head type	<ul style="list-style-type: none"> •Hands big handle head
Castor wheels	<ul style="list-style-type: none"> ◊Yes and not customized
Buzzer	<ul style="list-style-type: none"> •Yes and not customized
Vertical handler working	<ul style="list-style-type: none"> •Yes and not customized
Drive assembly	<ul style="list-style-type: none"> •Yes and not customized

Note: •Standard ◊ Optional - Inconformity

Feature



OPTIMIZED STRUCTURE, EASY OPERATION

The metal protective cover of battery can be flipped over, which can effectively protect the battery;

The battery has simple cover with two combination modes, it can prevent the battery from plugging and unplugging at will.

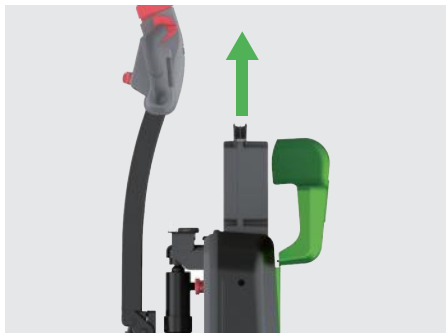

NEW DESIGN OF PLUG-IN&OUT BATTERY

The truck uses on-board chargers and it can be charged whenever and wherever you want.

The truck can be equipped with Li-Ion batteries of 30Ah, which can meet different kinds of working condition .

Li-ion battery developed by EP is equipped with BMS(battery management system), which is more convenient to use.



RIGOROUS DESIGN, STABLE OPERATION

It is equipped with industrial floating universal wheels as standard and offers great passability.



RELIABLE DRIVE SYSTEM

CBDL15E adopts the same mature and reliable drive system of CBDL15E, and its gradeability can reach 10% even with the load of 1000kg.



Electric Pallet Truck 1.5t

CBDL15-2

- SMALL SIZE, LIGHT SERVICE WEIGHT, SIMPLE OPERATION;
- ENERGY-SAVING AND ENVIRONMENTAL, LOWER COST;
- MORE CONVENIENT FOR MAINTENANCE.



Conforms to EN ISO3691-1
EN1175-1
EN16307-1
Based on Directive 2006/42/EC
Conform to EN Standard 12895
Based on directive: 2014/30/EU (EMC)

Model		CBDL15-2
Drive unit		Electrics
Operator type		pedestrian
rated capacity	Q (kg)	1500
Load center distance	c (mm)	600
Load distance	x (mm)	940(875)
Wheelbase	y (mm)	1202/1261
Service weight (include battery)	kg	195
Axle loading, laden driving side/loading side	kg	567/1128
Axle loading, unladen driving side/loading side	kg	155/40
Tyre type driving wheels/loading wheels		PU/PU
Tyre size, driving wheels (diameter×width)	mm	Φ210x70
Tyre size, loading wheels (diameter×width)	mm	2x Φ78x60 (Φ78x88)
Tyre size, caster wheels (diameter×width)	mm	-----
Wheels, number driving caster/loading (x=drive wheels)	mm	1x /4 (1x /2)
Track width, front,driving side	b ₁₀ (mm)	448
Track width,rear,loading side	b ₁₁ (mm)	410(535)
Lift height	h ₃ (mm)	115
Height drawbar in driving position min./max	h ₁₄ (mm)	750/1175
Lowered height	h ₁₃ (mm)	80
Overall length	l ₁ (mm)	1638
Length to face of forks	l ₂ (mm)	488
Overall width	b ₁ /b ₂ (mm)	560(685)
Fork dimensions	s/e/l (mm)	50/150/1150
Outside width of the forks	b ₅ (mm)	560 (685)
Ground clearance, center of wheelbase	m ₂ (mm)	30
Aisle width for pallets 1000 x 1200 crossways	Ast (mm)	1739
Aisle width for pallets 800 x 1200 lengthways	Ast (mm)	1939
Turning radius	Wa (mm)	1485
Travel s peed, laden/ unladen	km/h (km/h)	4/4.5
Lifting speed, laden/ unladen	m/s	0.027/0.038
Lowering speed, laden/ unladen	m/s	0.059/0.039
Max. gradeability , laden/unladen	%	5/16
Serice brake type		Electromagnetic
Drive motor rating S2 60 min	kW	0.65
Lift motor rating at S3 15%	kW	0.84
The maximum allowed size battery	mm	265*185*215
Battery voltage/nominal capacity K20	V/Ah	2x12/65Ah
Battery weight	kg	22.5X2
Type of drive control		DC
Steering type		Mechanical
Sound press ure level at the driver's ear	dB(A)	74

If there are improvements of technical parameters or configurations, no further notice will be given.
The diagram shown may contain non-standard configurations.

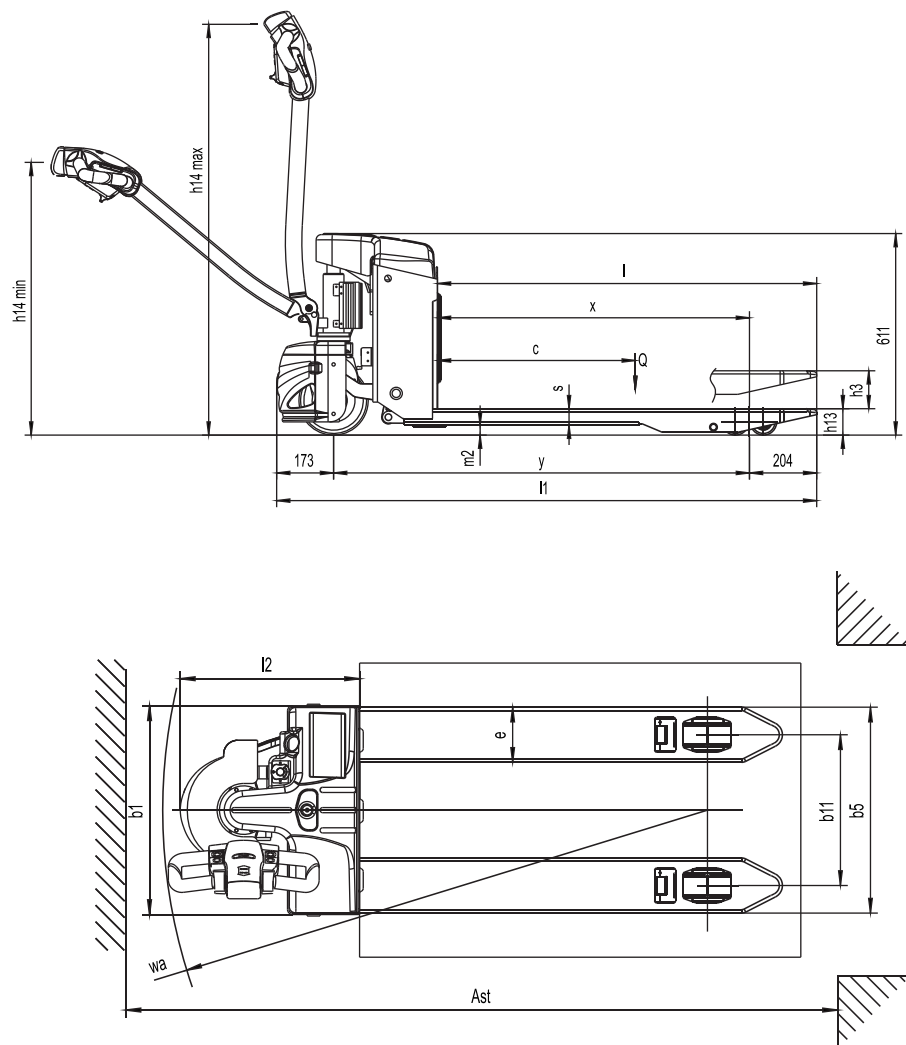

OPTION:

Optional items	Type	CBDL15-2
Forklength		○700 ~ 1500
Forkwidth		○520/600
Singleloadwheel	groundclearance75mm	○
Drivingwheel		○PUwheelwithPattern
Balancewheel		○
Batterycapacity		○85AH
Verticalhandlerworking		○
Inandoutofthetrayguidewheel		○
Specialbackrest		○1220mm (48in) /1520mm (60in)
Note: Forklength < 1400, capacity1.5T; Forklength≥1400, capacity1.0T		
Note: ●standard ○option —NA		

Feature

PATENTED DESIGN:

Ergonomic tiller bounded with key switch, BDI and trouble-shooting indicator enhances easy and accurate operation.

LIGHT WEIGHT, GREAT CAPACITY, GREAT PASSINGABILITY

Lightweight & compact size create excellent maneuverability & passingability. 1500KG capacity handles most applications.



EXTERNAL CONTROL SYSTEM

Patent designed external control system not only protects controller in place but also provides easy access for maintenance.

OPTIMIZED HARNESS LAYOUT

Optimized wire harness layout lowers twist failure rate.

FRONT DETACHABLE

Battery Cover: Innovative Design, Easy for Battery Replacement.

EMERGENCY SWITCH

Upgraded emergency switch ensures safety.

COVER FOR DRIVING WHEEL

Strong cover for driving wheel ensures the safety of the operator.

CHARGER

Upper-installed Charger, Better Heat-Exhausting, Higher Charging Efficiency





Electric Pallet Truck 1.5t

CBDL15-3

- HIGH STABILITY BY IMPROVED SUPPORT WHEELS.
- MAINTENANCE-FREE BATTERIES.
- LONG BATTERY LIFE
- IMPROVED FOOT PROTECTION



Model		CBDL15-3
Drive unit		Electrics
Operator type		pedestrian
rated capacity	Q (kg)	1500
Load center distance	c (mm)	600
Load distance	x (mm)	885/946
Wheelbase	y (mm)	1200(1269)
Service weight (include battery)	kg	190
Axle loading, laden driving side/loading side	kg	560/1130
Axle loading, unladen driving side/loading side	kg	145/45
Tyre type driving wheels/loading wheels		PU/PU
Tyre size, driving wheels (diameter×width)		Φ210x70
Tyre size, loading wheels (diameter×width)		2XΦ80x61(Φ78x88)
Tyre size, caster wheels (diameter×width)		Φ74x30
Wheels, number driving caster/loading (x=drive wheels)		1x 2/4(1x 2/2)
Track width, front,driving side	b ₁₀ (mm)	446
Track width,rear,loading side	b ₁₁ (mm)	410/(535)
Lift height	h ₃ (mm)	115
Height drawbar in driving position min./max	h ₁₄ (mm)	810/1200
Lowered height	h ₁₃ (mm)	80
Overall length	l ₁ (mm)	1620
Length to face of forks	l ₂ (mm)	473
Overall width	b ₁ /b ₂ (mm)	645(685)
Fork dimensions	s/e/l (mm)	50/150/1150
Outside width of the forks	b ₅ (mm)	560 (685)
Ground clearance, center of wheelbase	m ₂ (mm)	30
Aisle width for pallets 1000 x 1200 crossways	Ast (mm)	2280
Aisle width for pallets 800 x 1200 lengthways	Ast (mm)	2150
Turning radius	Wa (mm)	1475
Travel s peed, laden/ unladen	(km/h)km/h	4.5/5
Lifting speed, laden/ unladen	m/s	0.024/0.03
Lowering speed, laden/ unladen	m/s	0.059/0.05
Max. gradeability , laden/unladen	%	5/16
Serice brake type	tt	Electric
Drive motor rating S2 60 min	kW	0.75
Lift motor rating at S3 15%	kW	0.8
The maximum allowed size battery	mm	260*170*220
Battery voltage/nominal capacity K20	V/Ah	2x12/65Ah
Battery weight	kg	14.15x2
Type of drive control		DC
Steering type		Mechanical
Sound press ure level at the driver's ear	dB (A)	<74

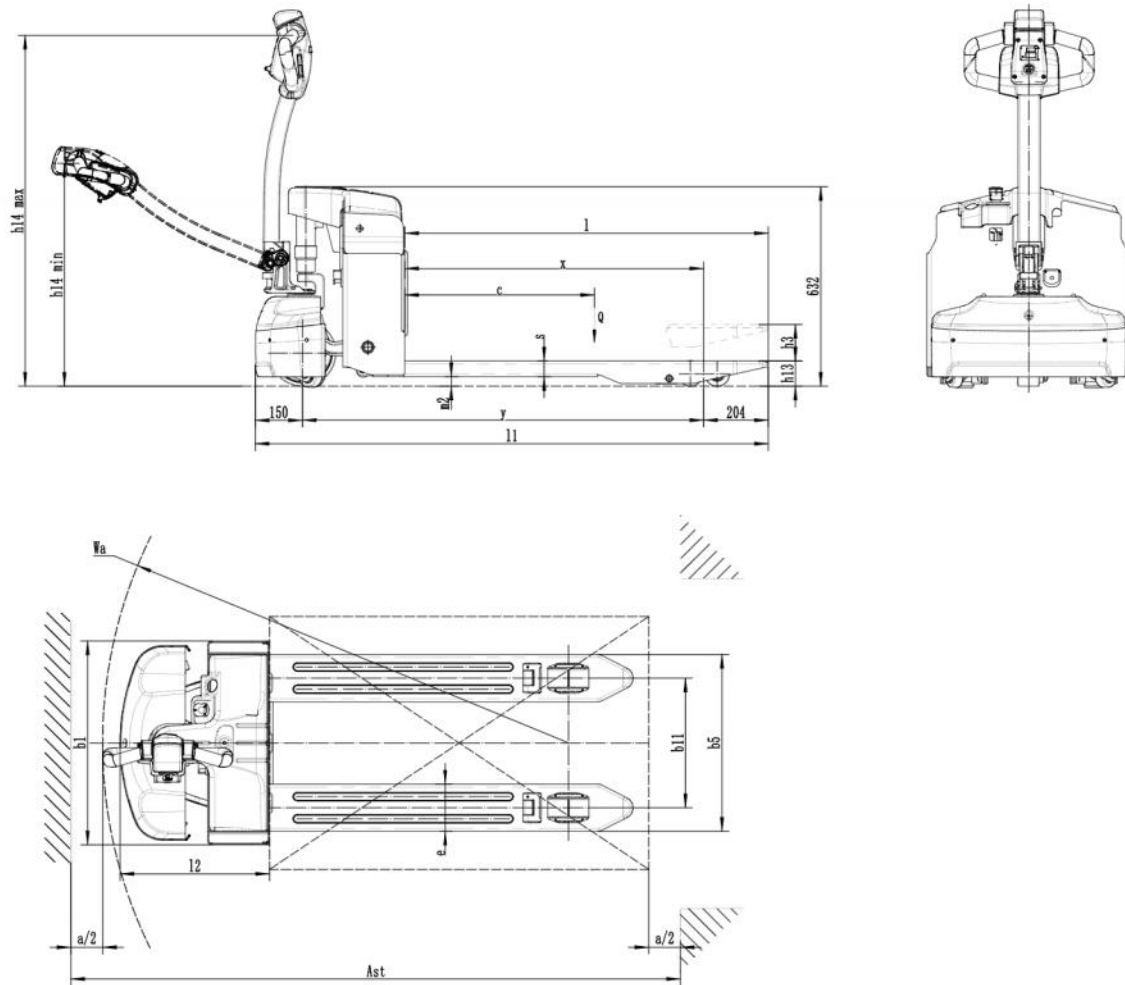

OPTION:

Optional items	CBDL15-3
Fork length	○ 1000/1150/1220mm
Fork width	○ 560/685mm
Single load wheel	○
Driving wheel	○ PU wheel with pattern
Balance wheel	●
Battery capacity	○ 85AH
Vertical handler working	●
In and out of the tray guide wheel	-
Special backrest	-

Note: Fork length < 1400, capacity 1.5T; Fork length ≥ 1400, capacity 1.0T

Note: ● standard ○ option - NA

Feature



HIGH STABILITY BY IMPROVED SUPPORT WHEELS

The truck can be equipped with improved castor wheels for higher stability Stepless speed control.



MAINTENANCE-FREE BATTERIES

CBD15 is equipped with AGM batteries as standard, which don't require manual maintenance like watering or an equalization charge.



LONG BATTERY LIFE

The CBD15 comes with two battery capacity types for selection, 65Ah and 85Ah, which allows the trucks to have high speed up to 5.0km/h, lasting driving hours, and high working efficiency.



IMPROVED FOOT PROTECTION

CBD15 comes with brake backing shields protects operators from pinch injuries.



Electric pallet truck 2.0t

CBDL20

48V SUPER POWER, IDEAL OUT-DOOR SOLUTION, LONGER RUN TIME

MASTERING URBAN LOGISTICS

DESIGNED TO COPE WITH COMPLEX ENVIRONMENT



High Obstacle



Road Bumps



Narrow Space

 Conforms to
ISO3691-1 EN1175-1
EN12053 EN12895
EN12100 EN16307-1

Model		CBDL20
Drive unit		Electrics
Operator type		pedestrian
rated capacity	Q (kg)	2000
Load center distance	c (mm)	600
Load distance	x (mm)	874/962
Wheelbase	y (mm)	1248/1336
Service weight (include battery)	kg	220
Axle loading, laden driving side/loading side	kg	722/1498
Axle loading, unladen driving side/loading side	kg	180/40
Tyre type driving wheels/loading wheels		Polyurethane
Tyre size, driving wheels (diameter×width)	mm	Φ230x74
Tyre size, loading wheels (diameter×width)	mm	2x Φ78x60
Tyre size, caster wheels (diameter×width)	mm	Φ74x30
Wheels, number driving caster/loading (x=drive wheels)	mm	1x2/4
Track width, front,driving side	b ₁₀ (mm)	435
Track width,rear,loading side	b ₁₁ (mm)	410(535)
Lift height	h ₃ (mm)	140
Height drawbar in driving position min./max	h ₁₄ (mm)	750/1170
Lowered height	h ₁₃ (mm)	80
Overall length	l ₁ (mm)	1685
Length to face of forks	l ₂ (mm)	535
Overall width	b ₁ /b ₂ (mm)	560(685)
Fork dimensions	s/e/l (mm)	50/150/1150
Outside width of the forks	b ₅ (mm)	560 (685)
Ground clearance, center of wheelbase	m ₂ (mm)	30
Aisle width for pallets 1000 x 1200 crossways	Ast (mm)	2304
Aisle width for pallets 800 x 1200 lengthways	Ast (mm)	2371
Turning radius	Wa (mm)	1550
Travel s peed, laden/ unladen	(km/h)km/h	4/5.5
Lifting speed, laden/ unladen	m/s	0.018/0.037
Lowering speed, laden/ unladen	m/s	0.032/0.038
Max. gradeability , laden/unladen	%	8/16
Serice brake type		Electromagnetic
Drive motor rating S2 60 min	kW	0.75
Lift motor rating at S3 15%	kW	0.84
Battery voltage/nominal capacity K20	V/Ah	12x4/30Ah
Battery weight	kg	9.5X4
Type of drive control		DC
Steering type		Mechanical
Sound press ure level at the driver's ear	dB (A)	74

CBDL20

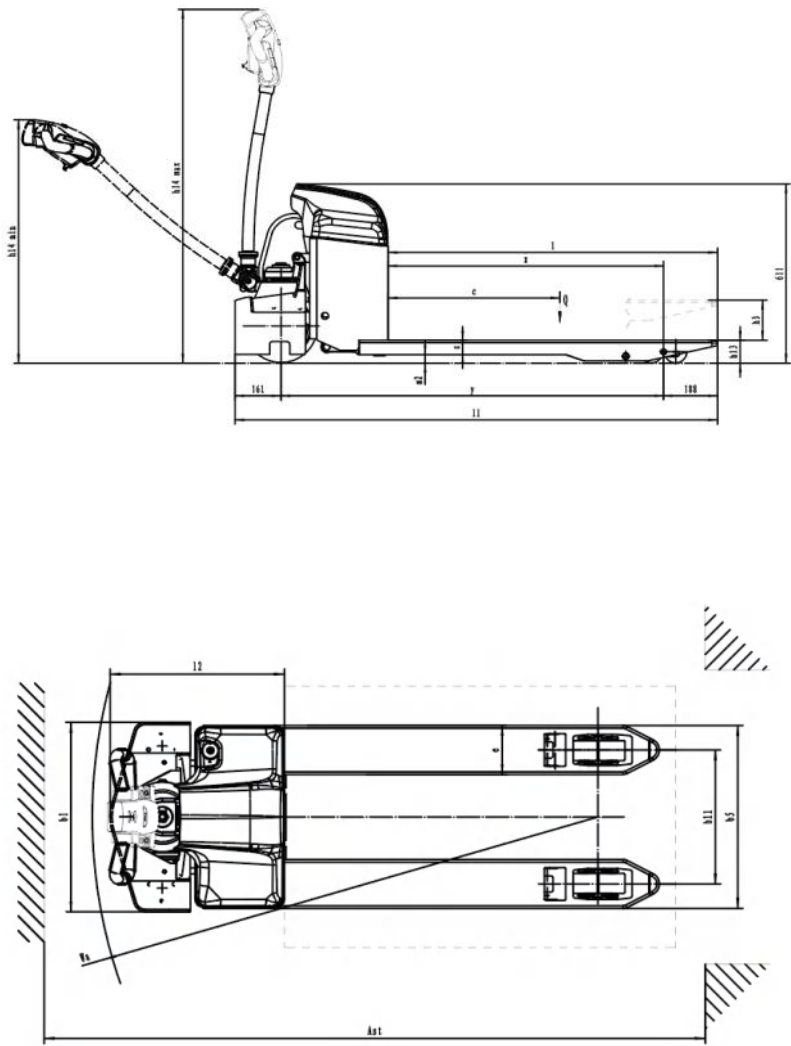

OPTION:

Options

Fork length

Climbing wheel load 1.6T

Driving wheel

Special backrest

Note:Fork length<1400.capacity2.0T; Fork length≥1400.capacity1.6T

Note: ● standard ○ option – NA

CBDL20

○ 800/915/1000/1070/1150/1220/1300

○

○ Rubber wheel

○ 1220mm(48in)/1520mm(60in)

Feature

Light service weight,high rated capacity,not limited by floor type:

Minimum size VS 2.0ton capacity,with 1465mm turning radius.

High passability design:

CBD20 can easily drive through 100mm height barrier with patent roll-over load wheel and large drive wheel.

80mm lowered height and 140mm lifting height giving flexibility for pallet and application.

Easy disassembly handle design:

Pin through tiller style reduces shipping cost and installation time greatly.

Innovative frame design:

Distribute majority weight to bottom chassis by patent designed cylinder structure.

DC brushless permanent magnet motor:

Life time maintenance free brushless permanent magnet motor.

Easy maintenance:

Electronic system and batteries can be completely exposed by pressing one -touch locker. Drive wheel can be replaced by loosening one nut. Retractable charging cord.

48V electronic system:

48V electronic system increases efficiency and reliability.

Shock absorb chassis design:

Special linkage design, minimize the driving difference between smooth ground and rough ground.



Rated Capacity up to
2000kg



Turning Radius
1465mm



Driving Wheels diameterxwidth
250x74mm



Lowered Height **80mm** | Max Lifting Height **220mm**



Optional Turnable load wheel to overcome obstacle **100mm**
(Note:Only available for CBD20)



Max. gradeability laden|unladen **8% | 16%**



Electric Rider Pallet Truck

CBD20R-II

CBD25R-II

CBD20R/25R is the stand-on type platform Pallet Truck, with small turning radius and super light steering system, widely used in large warehouse and big supermarket for medium distance transport.

CBD30R-II

CBD30R-II is the innovation type rider pallet truck for heavy duty work of pallet moving, high-speed load transport and loading dock work.

AC

EPS
(Option)



Conforms to EN ISO3691-1
EN1175-1
EN16307-1
Based on Directive 2006/42/EC
Conform to EN Standard 12895
Based on directive: 2014/30/EU (EMC)

Model		CBD20R-II	CBD25R-II	CBD30R-II
Drive: electric (battery type, mains, ...), diesel, petrol, fuel gas		Electric	Electric	Electric
Operator type: hand, pedestrian, standing, seated, order-picker		Standing	Standing	Standing
Rated capacity/rated load	Q (kg)	2000	2500	3000
Load centre distance	c (mm)	600	600	600
Load distance, centre of drive axle to fork	x (mm)	914/964/1034	914/964/1034	914/964/1034
Wheelbase	y (mm)	1211/1261/1331	1211/1261/1331	1286/1336/1406
Service weight	kg	710	740	820
Axle loading, laden front/rear	kg	1300/1410	1470/1770	1720/2100
Axle loading, unladen front/rear	kg	600/110	620/120	660/160
Tyres: solid rubber, superelastic, pneumatic, polyurethane		Polyurethane(PU)	Polyurethane(PU)	Polyurethane(PU)
Tyre size, front	mm	¢250*70	¢250*70	¢250*80
Tyre size, rear	mm	¢82*126(98)	¢82*126(98)	¢82*126(98)
Additional wheels (dimensions)	mm	¢127*57	¢127*57	¢127*57
Wheels, number front/rear (x = driven wheels)		1X-2/2(4)	1X-2/2(4)	1X-2/2(4)
Tread, front	b ₁₀ (mm)	537	537	537
Tread, rear	b ₁₁ (mm)	340/370/470/505	340/370/470/505	340/370/470/505
Lift	h ₃ (mm)	120	120	120
Height drawbar in driving position min./max.	h ₁₄ (mm)	1150/1430	1150/1430	1150/1430
Height, lowered	h ₁₃ (mm)	82	82	82
Overall length	l ₁ (mm)	1710/1760/1830	1710/1760/1830	1785/1835/1905
Length to face of forks	l ₂ (mm)	610	610	685
Overall width	b ₁ /b ₂ (mm)	775	775	775
Fork dimensions DIN ISO 2331	s/e/l (mm)	53/180/1100(1150/1220)	53/180/1100(1150/1220)	54/180/1100(1150/1220)
Fork spread	b ₅ (mm)	520/550/650/685	520/550/650/685	520/550/650/685
Ground clearance, centre of wheelbase	m ₂ (mm)	28	28	28
Aisle width for pallets 1000 × 1200 crossways	Ast (mm)	2360/2405/2475	2360/2405/2475	2435/2480/2550
Aisle width for pallets 800 × 1200 lengthways	Ast (mm)	2245/2270/2305	2245/2270/2305	2320/2345/2380
Turning radius	Wa (mm)	1550/1600/1670	1550/1600/1670	1550/1600/1670
Travel speed, laden/unladen	km/h	7.0/7.1	7.0/7.1	9.0/9.2
Lift speed, laden/unladen	m/s	0.025/0.035, 0.035/0.045	0.035/0.045	0.039/0.056
Lowering speed, lade/unladen	m/s	0.035/0.030, 0.060/0.055	0.060/0.055	0.064/0.050
Max. gradeability, laden/unladen	%	8/20	8/20	8/20
Service brake		Electromagnetic	Electromagnetic	Electromagnetic
Drive motor rating S2 60 min	kW	1.2, 1.5	1.5	2.2
Lift motor rating at S3 15%	kW	0.8, 1.2	1.2	2.2
Battery voltage/nominal capacity K5	(V)/(Ah) or kWh	24/210	24/240	24/240(280)
Battery weight	kg	195	235	235/275
Drive control		AC control	AC control	AC control
Sound pressure level at the driver' s seat	dB (A)	70	70	70

Option: Battery 240Ah / 400Ah; Drive speed 9.5-10km/h

Option with EPS drive wheel size is 250x80mm

Option: 

CBD20R-I/CBD25R-II Lithium battery 125AH (Charger 24V/50A)

CBD30R-II Lithium battery 225AH (Charger 24V/100A)

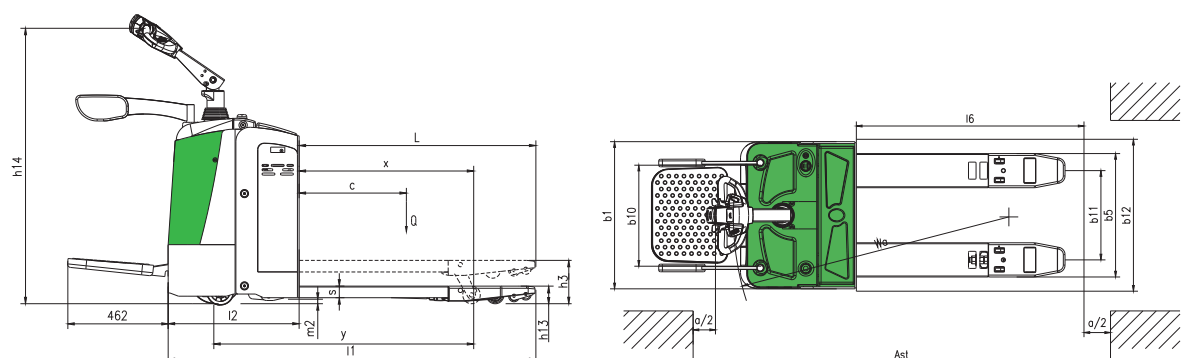



CBD20R-II CBD25R-II

STANDARD FEATURES

- RUYI handle
- Emergency stop & belly button
- BDI and hour meter
- Casters to balance stability
- Industrial battery
- Brushless AC motor
- Vertical driving motor
- Sideway battery change
- Built-out charger
- Platform with speed sensor

OPTION

- Fork width and length (size)
- Load backrest
- Built-in Charger
- Cold storage with rubber drive wheel
- Entry & exist roller for empty pallets
- EPS
- large compartment with battery capacity 280Ah, 400Ah
- CBD20R-II/CBD25R-II: Lithium battery 24V/1 25AH
- CBD30R-II: Lithium battery 24V/225AH

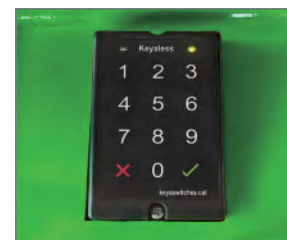

Keypad access (option)



RUYI Handle (standard)



Frei tiller head with one side lifting button (option)



Frei tiller head with two lifting button (option)



Entry roller for easy operation

CBD30R-II

SAFETY AND PRODUCTIVITY

- AC control system eliminating motor brushes and directional contactors, which minimizes maintenance requirements.
- Multi-function display: battery status, hour meter, fault code, etc.
- Side-way battery with roll-out system is very convenient to replace batteries.
- Emergency reversing device.
- The platform with speed sensor under platform, ensure safety driving.
- Built-in pressure relief valve protects the truck from overloads.
- Braking applied with handle upright and horizontal position.
- Emergency power disconnect switch.
- Low speed switch in the handle(option with bypass function)

SERVICEABILITY

- Adjustable integrated balance wheel can be disassembled from truck separately, easy to maintain.
- The platform can be removed from the truck easily for replacement or repair.
- Low battery voltage cut off protection.

STRUCTURAL

- Parallel motor mounting on vertical drive wheel ensures convenience for inspection and maintenance while also ensuring a small turning radius.
- The structure of motor is water-proof and dust-proof, which makes the brake and motor more durable and reliable.
- Combined balance wheels and driving system increase steadiness, preventing the truck from being rocked from side to side.
- The balance wheels loading capacity can be adjusted according to different situations.
- One-piece heavy gauge steel is formed for maximum strength forks.





TEL: 0086-532-66739792

FAX: 0086-532-66739791

info@movmes.com

NO.88 Chunyang Road,Chengyang,
QINGDAO,CHINA

www.movmes.com